

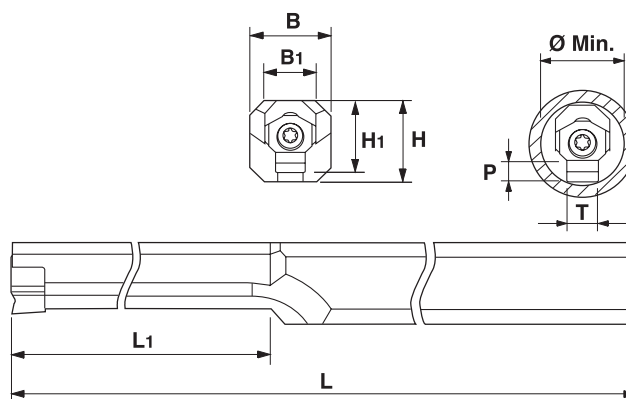

Herramientas y plaquitas para mortajadora	312
Herramientas soldadas	314
Herramientas convencionales ISO.....	318
Herramientas convencionales ISO de interior	318
Otra herramientas de torneado	320
Barras de mandrinar	320
Cabezal para mandrinar	321
Herramientas de mandrinar con mango redondo..	323
Herramientas soldadas y sólidas	323
Herramientas rotatorias	328
Herramientas con plaquitas indexables	328
Herramientas soldadas	329
Soportes	331
Soporte para herramientas rotatorias.....	331
Casquillos para barras de mandrinar	331
Soporte dinamométrico para corte	332
Soporte para cuchillas de tronzado	
Trapezoidales	333
Romboides.....	333
Herramientas de moldeado HSS.....	334
Cuadrada	334
Redonda	334
Trapezoidal.....	334
Rectangular	335
Soportes de herramientas	336
Soportes de herramientas giratorios.....	336
Soporte universal	337
Portaherramientas de cono morse	338
Portaherramientas múltiple	338
Soportes para soportes de herramientas P3/70 ...	339
Soportes de cono morse para soportes P3/70.....	340
Distribuidor de refrigerante y accesorios	341

HERRAMIENTAS Y PLAQUITAS PARA MORTAJADORA

PHZ

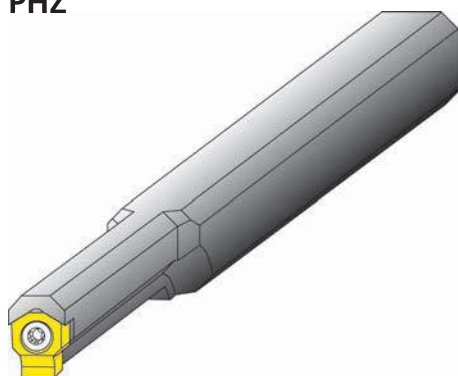

Referencia	Dimensiones (mm)									Piezas de repuesto	
	H	H ₁	B	B ₁	L ₁	L	T	Ø min.	P max		
PHZ 90 1104-06	11.3	9	11.3	8.5	35	160	3	9.5	1.6	DVF 3593	TX 207PLUS
PHZ 90 1107-06	11.3	10	11.3	7	60	200	4 5	10.9 11.1	2.5 3	DVF 3593	TX 207PLUS
PHZ 90 1111-06	11.3	12	11.3	-	60	200	4 5	14 14	2.5 3	DVF 3593	TX 207PLUS
PHZ 1512-10	15.5	16.2	12	-	-	220	6 8	17.8 18.2	4.2 5.2	DVF 2260	TX 215PLUS
PHZ 2014-13	20.6	21.5	14	-	-	250	10 12	24.2 24.7	6.2 7.2	5513 020-14	TX 225PLUS

HZ

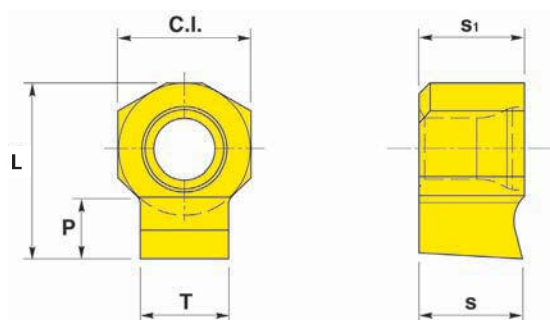



Referencia	Dimensiones (mm)							Calidad	
	C.I.	S	S ₁	L	P	T	Tolerancias en T	333TN	
HZ 90 06 04-30 C11	6	4.66	4.76	7.5	1.6	3	+0.060 +0.012	✓	
HZ 90 06 04-40 C11	6	4.66	4.76	8.0	2.5	4	+0.070 +0.145	✓	
HZ 90 06 04-50 C11	6	4.66	4.76	8.0	3.0	5	+0.070 +0.145	✓	
HZ 10 06-60 C11	10	6.25	6.35	13.5	4.2	6	+0.070 +0.145	✓	
HZ 10 06-80 C11	10	6.25	6.35	13.5	5.2	8	+0.080 +0.170	✓	
HZ 13 09-100 C11	13	9.40	9.525	18.5	6.2	10	+0.080 +0.170	✓	
HZ 13 09-120 C11	13	9.40	9.525	18.5	7.2	12	+0.095 +0.205	✓	
HZ 90 06 04-30 H7	6	4.66	4.76	7.5	1.6	3	+0.090 -0	✓	
HZ 90 06 04-40 H7	6	4.66	4.76	8.0	2.5	4	+0.012 -0	✓	
HZ 90 06 04-50 H7	6	4.66	4.76	8.0	3.0	5	+0.012 -0	✓	
HZ 10 06-60 H7	10	6.25	6.35	13.5	4.2	6	+0.012 -0	✓	
HZ 10 06-80 H7	10	6.25	6.35	13.5	5.2	8	+0.015 -0	✓	
HZ 13 09-100 H7	13	9.40	9.525	18.5	6.2	10	+0.015 -0	✓	
HZ 13 09-120 H7	13	9.40	9.525	18.5	7.2	12	+0.018 -0	✓	
HZ 90 06 04-30 D10	6	4.66	4.76	7.5	1.6	3	+0.060 +0.002	✓	
HZ 90 06 04-40 D10	6	4.66	4.76	8.0	2.5	4	+0.078 +0.030	✓	
HZ 90 06 04-50 D10	6	4.66	4.76	8.0	3.0	5	+0.078 +0.030	✓	

Ejemplo de pedido: PHZ 90 1104-06

HERRAMIENTAS Y PLAQUITAS PARA MORTAJADORA

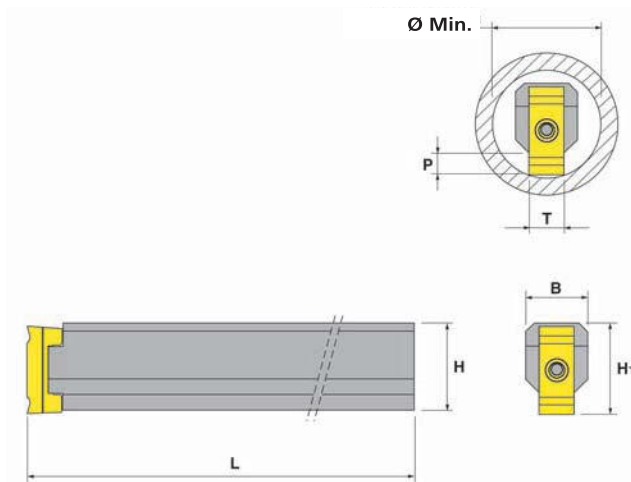
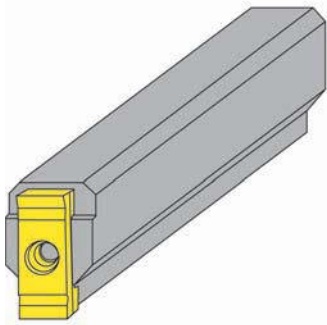
PHZ/2



Referencia	Dimensiones (mm)							Piezas de repuesto	
	H	H ₁	B	L	T	Ø min.	P max		
PHZ/2 3625-14	36	37.5	25	300	14 16	44	8 9	5513 020-14	TX 225PLUS
PHZ/2 4838-18	48	50	32	400	18 20	58	12 13	5513 021-03	DMN 3124

HZ/2 - Dos filos

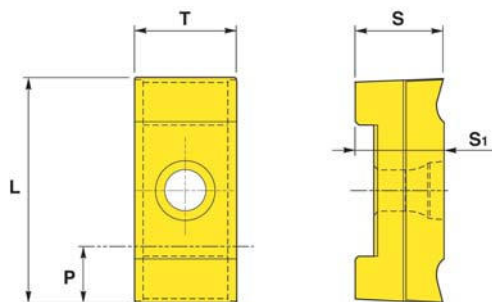

Referencia	Dimensiones (mm)						Tolerancias en T	Calidad 333TN
	S	S ₁	L	P	T			
HZ/2 14-14 C11	13.9	14	36	8	14	+0.205 +0.095	✓	
HZ/2 16-16 C11	13.9	14	36	9	16	+0.205 +0.095	✓	
HZ/2 18-18 C11	15.9	16	45	12	18	+0.205 +0.095	✓	
HZ/2 20-20 C11	15.9	16	45	13	20	+0.240 +0.110	✓	
HZ/2 14-14 H7	13.9	14	36	8	14	+0.018 -0	✓	
HZ/2 16-16 H7	13.9	14	36	9	16	+0.018 -0	✓	
HZ/2 18-18 H7	15.9	16	45	12	18	+0.018 -0	✓	
HZ/2 20-20 H7	15.9	16	45	13	20	+0.021 -0	✓	

Ejemplo de pedido: PHZ/2 3625-14

HERRAMIENTAS CONVENCIONALES ISO

ISO 1 R

UNI 4102 R
DIN 4971

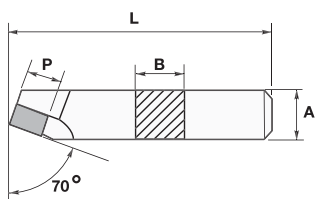

Referencia	Dimensiones (mm)			Plaquita
	A	B	L	P
ISO 1 R 1010	10	10	90	C8
ISO 1 R 1212	12	12	100	C10
ISO 1 R 1616	16	16	110	C12
ISO 1 R 2020	20	20	125	C16
ISO 1 R 2525	25	25	140	C20

ISO 1 L

UNI 4102 L
DIN 4971

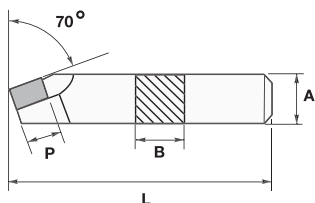

Referencia	Dimensiones (mm)			Plaquita
	A	B	L	P
ISO 1 L 1212	12	12	100	C10
ISO 1 L 1616	16	16	110	C12
ISO 1 L 2020	20	20	125	C16

ISO 2 R

UNI 4103 R
DIN 4972

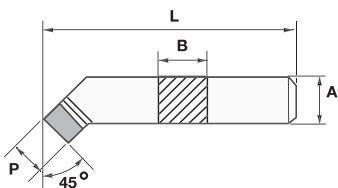

Referencia	Dimensiones (mm)			Plaquita
	A	B	L	P
ISO 2 R 1010	10	10	90	C8
ISO 2 R 1212	12	12	100	C10
ISO 2 R 1616	16	16	110	C12
ISO 2 R 2020	20	20	125	C16
ISO 2 R 2525	25	25	140	C20
ISO 2 R 3232	32	32	170	C25

ISO 2 L

UNI 4103 L
DIN 4972

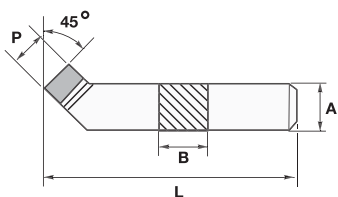

Referencia	Dimensiones (mm)			Plaquita
	A	B	L	P
ISO 2 L 1010	10	10	90	C8
ISO 2 L 1212	12	12	100	C10
ISO 2 L 1616	16	16	110	C12
ISO 2 L 2020	20	20	125	C16
ISO 2 L 2525	25	25	140	C20
ISO 2 L 3232	32	32	170	C25

ISO 6 R

UNI 4104 R
DIN 4980

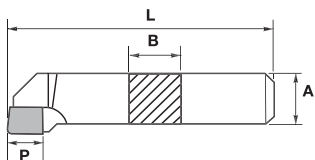

Referencia	Dimensiones (mm)			Plaquita
	A	B	L	P
ISO 6 R 1010	10	10	90	C8
ISO 6 R 1212	12	12	100	ABC 10
ISO 6 R 1616	16	16	110	ABC 12
ISO 6 R 2020	20	20	125	ABC 16
ISO 6 R 2525	25	25	140	ABC 20
ISO 6 R 3232	32	32	170	ABC 25

Ejemplo de pedido: ISO 1 R 1010

HERRAMIENTAS CONVENCIONALES ISO

ISO 6 L

UNI 4104 L
DIN 4980

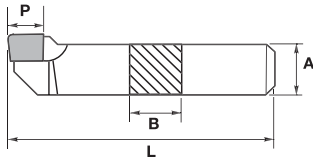

Referencia	Dimensiones (mm)			Plaquita
	A	B	L	P
ISO 6 L 1010	10	10	90	C8
ISO 6 L 1212	12	12	100	ABC 10
ISO 6 L 1616	16	16	110	ABC 12
ISO 6 L 2020	20	20	125	ABC 16
ISO 6 L 2525	25	25	140	ABC 20
ISO 6 L 3232	32	32	170	ABC 25

351

UNI 4105
DIN 4975

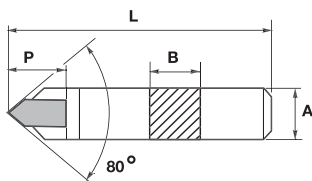

Referencia	Dimensiones (mm)			Plaquita
	A	B	L	P
351 1010	10	10	90	E8-IMP
351 1212	12	12	100	E10-IMP
351 1220	12	20	125	E12-IMP
351 1616	16	16	110	E12-IMP
351 1625	16	25	140	E8-ISO
351 2020	20	20	125	E8-ISO
351 2525	25	25	140	E10-ISO

ISO 3 R

UNI 4106 R
DIN 4978

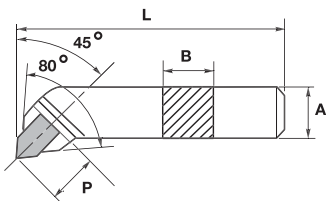

Referencia	Dimensiones (mm)			Plaquita
	A	B	L	P
ISO 3 R 1212	12	12	100	E12-IMP
ISO 3 R 1616	16	16	110	E8-ISO
ISO 3 R 2020	20	20	125	E10-ISO
ISO 3 R 2525	25	25	140	E12-ISO

ISO 3 L

UNI 4106 L
DIN 4978

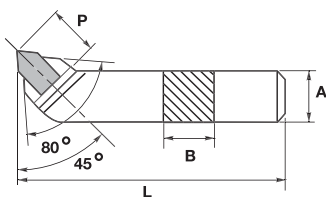

Referencia	Dimensiones (mm)			Plaquita
	A	B	L	P
ISO 3 L 1616	16	16	110	E8-ISO
ISO 3 L 2020	20	20	125	E10-ISO
ISO 3 L 2525	25	25	140	E12-ISO

ISO 4

UNI 4107
DIN 4976

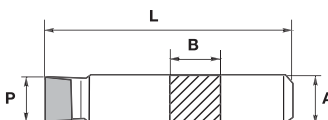

Referencia	Dimensiones (mm)			Plaquita
	A	B	L	P
ISO 4 1010	10	10	90	ABC 10
ISO 4 1212	12	12	100	ABC 12
ISO 4 1616	16	16	110	ABC 16
ISO 4 2020	20	20	125	ABC 20
ISO 4 2525	25	25	140	ABC 25

Ejemplo de pedido: ISO 6 L 1010

HERRAMIENTAS CONVENCIONALES ISO

ISO 5 R

UNI 4108 R
DIN 4977

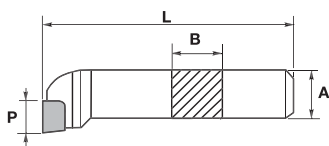

Referencia	Dimensiones (mm)			Plaquita
	A	B	L	P
ISO 5 R 1212	12	12	100	ABC 10
ISO 5 R 1616	16	16	110	ABC 12
ISO 5 R 2020	20	20	125	ABC 16

ISO 5 L

UNI 4108 L
DIN 4977

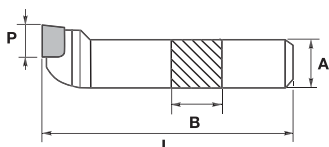

Referencia	Dimensiones (mm)			Plaquita
	A	B	L	P
ISO 5 L 2020	20	12	125	ABC 16

ISO 7 R

UNI 4109 R
DIN 4981

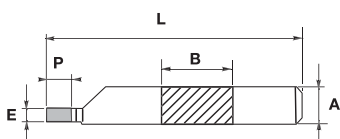

Referencia	Dimensiones (mm)				Plaquita
	A	B	L	E	P
ISO 7 R 0812	8	12	100	3	D3
ISO 7 R 1010	10	10	90	3	D3
ISO 7 R 1016	10	16	110	4	D4
ISO 7 R 1212	12	12	100	3	D3
ISO 7 R 1220	12	20	125	5	D5
ISO 7 R 1616	16	16	110	4	D4
ISO 7 R 1625	16	25	140	6	D6
ISO 7 R 2020	20	20	125	5	D5
ISO 7 R 2032	20	32	170	8	D8
ISO 7 R 2525	25	25	140	6	D6
ISO 7 R 2540	25	40	200	10	D10

ISO 7 L

UNI 4109 L
DIN 4981

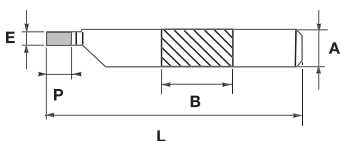

Referencia	Dimensiones (mm)				Plaquita
	A	B	L	E	P
ISO 7 L 0812	8	12	100	3	D3
ISO 7 L 1016	10	16	110	4	D4
ISO 7 L 1220	12	20	125	5	D5
ISO 7 L 1625	16	25	140	6	D6
ISO 7 L 2020	20	20	125	5	D5
ISO 7 L 2032	20	32	170	8	D8
ISO 7 L 2540	25	40	200	10	D10

352 R 55°

UI 30 R 55°

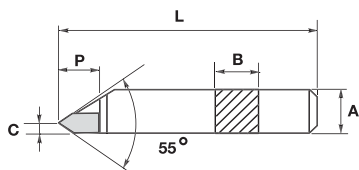

Referencia	Dimensiones (mm)				Plaquita
	A	B	L	C	P
352 R 55° 1212	12	12	100	2	FIL 3,5
352 R 55° 1616	16	16	110	2	FIL 4
352 R 55° 2020	20	20	125	2.5	FIL 5
352 R 55° 2525	25	25	140	3	FIL 6

Ejemplo de pedido: ISO 5 R 1212

HERRAMIENTAS CONVENCIONALES ISO

352 L 55°

UI 30 L 55°

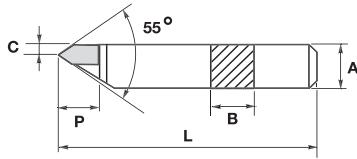

Referencia	Dimensiones (mm)				Plaquita
	A	B	L	C	P
352 L 55° 2020	20	20	125	2.5	FIL 5

352 R 60°

UI 30 R 60°

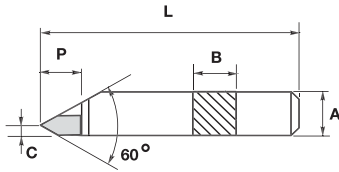

Referencia	Dimensiones (mm)				Plaquita
	A	B	L	C	P
352 R 60° 1212	12	12	100	2	FIL 3,5
352 R 60° 1616	16	16	110	2	FIL 4
352 R 60° 2020	20	20	125	2.5	FIL 5
352 R 60° 2525	25	25	140	3	FIL 6

352 L 60°

UI 30 L 60°

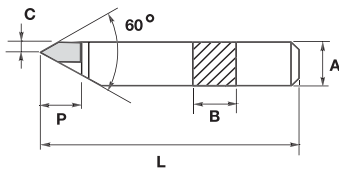

Referencia	Dimensiones (mm)				Plaquita
	A	B	L	C	P
352 L 60° 1616	16	16	110	2	FIL 4
352 L 60° 2020	20	20	125	2.5	FIL 5
352 L 60° 2525	25	25	140	3	FIL 6

UI 70 R

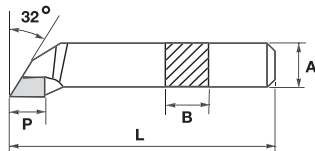

Referencia	Dimensiones (mm)				Plaquita
	A	B	L	C	P
UI 70 R 1616	16	16	140	-	CP 12
UI 70 R 2020	20	20	160	-	CP 16
UI 70 R 2525	25	25	200	-	CP 20

UI 70 L

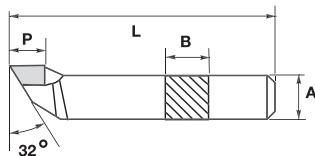

Referencia	Dimensiones (mm)				Plaquita
	A	B	L	C	P
UI 70 L 2020	20	20	160	-	CPS 16

Ejemplo de pedido: 352 L 55° 2020

HERRAMIENTAS CONVENCIONALES ISO DE INTERIOR

ISO 8

UNI 4110 R
DIN 4973

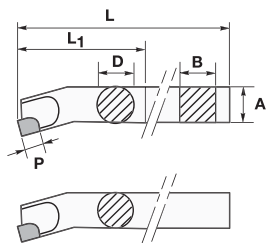

Referencia	Dimensiones (mm)							Plaquita
	A	B	D	L	L ₁	P	C	P
ISO 8 0808	8	8	8	125	40	-	-	C6
ISO 8 1010	10	10	10	150	50	-	-	C7
ISO 8 1212	12	12	12	180	63	-	-	C8
ISO 8 1616	16	16	16	210	80	-	-	C10
ISO 8 2020	20	20	20	250	100	-	-	C12
ISO 8 2525	25	25	25	300	125	-	-	C16
ISO 8 3232	32	32	32	355	160	-	-	C20
ISO 8 0008	-	-	8	125	-	-	-	C6
ISO 8 0010	-	-	10	150	-	-	-	C7
ISO 8 0012	-	-	12	180	-	-	-	C8
ISO 8 0016	-	-	16	210	-	-	-	C10

ISO 9

UNI 4110 R
DIN 4974

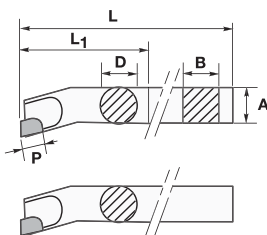

Referencia	Dimensiones (mm)							Plaquita
	A	B	D	L	L ₁	P	C	P
ISO 9 0808	8	8	8	125	40	-	-	C6
ISO 9 1010	10	10	10	150	50	-	-	C7
ISO 9 1212	12	12	12	180	63	-	-	C8
ISO 9 1616	16	16	16	210	80	-	-	C10
ISO 9 2020	20	20	20	250	100	-	-	C12
ISO 9 2525	25	25	25	300	125	-	-	C16
ISO 9 3232	32	32	32	355	160	-	-	C20
ISO 9 0008	-	-	8	125	-	-	-	C6
ISO 9 0010	-	-	10	150	-	-	-	C7
ISO 9 0012	-	-	12	180	-	-	-	C8
ISO 9 0016	-	-	16	210	-	-	-	ABC 10
ISO 9 0020	-	-	20	250	-	-	-	ABC 12
ISO 9 0025	-	-	25	300	-	-	-	ABC 16

353 R 55°

UI 40 R 55°

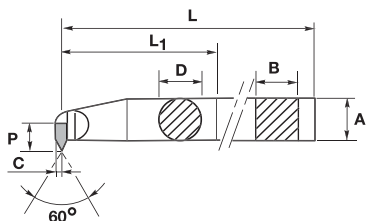

Referencia	Dimensiones (mm)							Plaquita
	A	B	D	L	L ₁	P	C	P
353 R 55° 1010	10	10	10	140	52	12	1.8	FIL 3,5
353 R 55° 1212	12	12	12	160	56	12	1.8	FIL 3,5
353 R 55° 1616	16	16	16	180	63	14	2	FIL 4
353 R 55° 2020	20	20	20	210	80	14	2	FIL 4

Ejemplo de pedido: ISO 8 0808

HERRAMIENTAS CONVENCIONALES ISO DE INTERIOR

353 R 60°

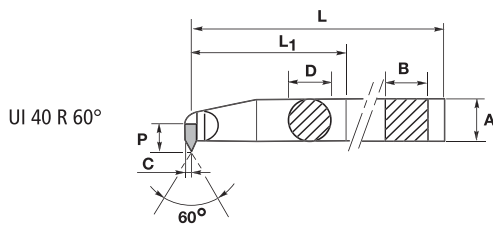

Referencia	Dimensiones (mm)							Plaquita	
	A	B	D	L	L ₁	P	C	P	
353 R 60° 1010	10	10	10	140	52	12	1.8	FIL 3,5	
353 R 60° 1212	12	12	12	160	56	12	1.8	FIL 3,5	
353 R 60° 1616	16	16	16	180	63	14	2	FIL 4	
353 R 60° 2020	20	20	20	210	80	14	2	FIL 4	
353 R 60° 2525	25	25	25	250	100	16	2.5	FIL 5	

354 R

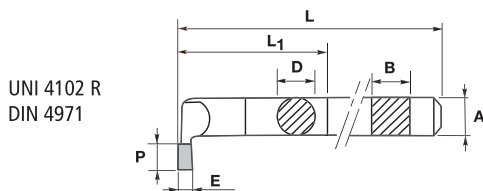





Referencia	Dimensiones (mm)							Plaquita	
	A	B	D	L	L ₁	P	E	P	
354 R 1010	10	10	10	140	52	8	3	D3	
354 R 1212	12	12	12	160	56	10	4	D4	
354 R 1616	16	16	16	180	63	12	5	D5	
354 R 2020	20	20	20	210	80	14	6	D6	
354 R 2525	25	25	25	250	100	16	8	D8	

Ejemplo de pedido: 353 R 60° 1010

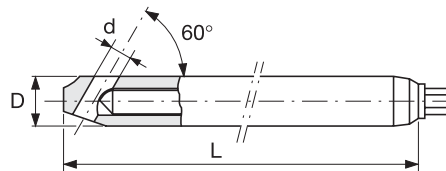
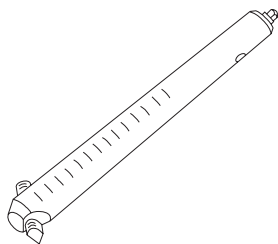
BARRAS DE MANDRINAR

SI



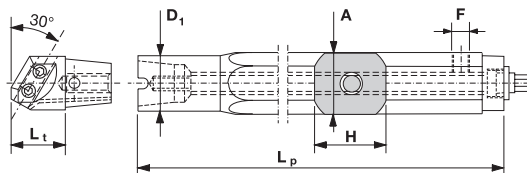
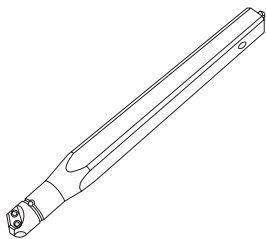

Referencia	Dimensiones (mm)			Piezas de repuesto		
	D	L	d			
SI-10-04	10	180	4	2005	1361	1502
SI-12-05	12	210	5	2015	1361	1502
SI-16-07	16	250	7	2025	1081	1504
SI-20-08	20	300	8	2035	1102	1504
SI-25-10	25	350	10	2055	1121	1504
SI-32-12	32	400	12	2075	1423	1504

P51



La barra de mandrinar se suministra completa con cabeza T 51

Referencia	Dimensiones (mm)						Piezas de repuesto		
	H	A	D ₁	L _p	L _p +L _t	F			
P51-4036-32+T51	40	36	32	446	480	3/8»Gas	1141	2335	1506
P51-5645-45+T51	56	45	45	546	590	3/8»Gas	1142	2335	1506
P51-7660-55+T51	77	58	55	700	762	3/8»Gas	1201	2346	1509
P51-8660-55+T51	86	60	55	1000	1062	3/8»Gas	1205	2346	1509

Ejemplo de pedido: SI-10-04

CABEZAL PARA MANDRINAR

T 51/60

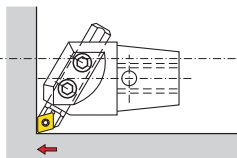

T 53 C

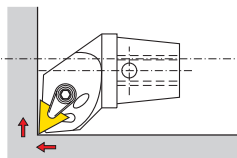

T 53 S

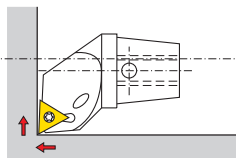

T 27 M

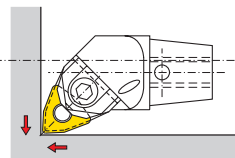

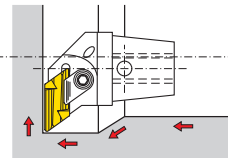

T 64 C



Los cabezales van provistos con un canal interno permitiendo que el refrigerante alcance la punta de la herramienta.

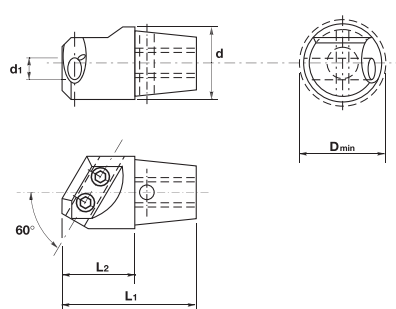
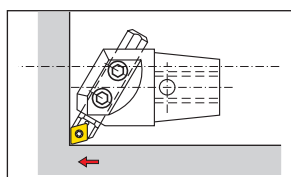



T51/60

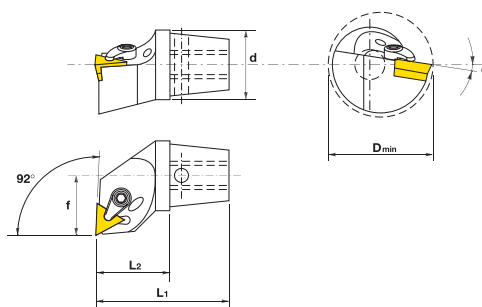
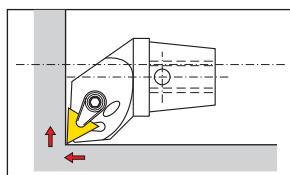

Referencia	Dimensiones (mm)					Piezas de repuesto	
	d	d ₁	L ₁	L ₂	D _{min}		
T51/60-32-12	32	12	56	31	35	UNI 5923 M8x10	UNI 2415-4
T51/60-45-16	45	16	72	42	50	UNI 5923 M10x12	UNI 2415-5
T51/60-55-22	55	22	100	60	60	UNI 5923 M12x16	UNI 2415-6

T53C



Referencia	Dimensiones (mm)						Piezas de repuesto				
	d	f	L ₁	L ₂	α	D _{min}					
T53C-32-TP16	32	27	58	33	0°	45	TP 212	S2-10	M6x19 RL	MC 2	UNI 2415-3
T53C-45-TP16	45	35	70	40	0°	60	TP 212	S2-10	M6x19 RL	MC 2	UNI 2415-3

Ejemplo de pedido: T51/60-32-12

CABEZAL PARA MANDRINAR

T53S

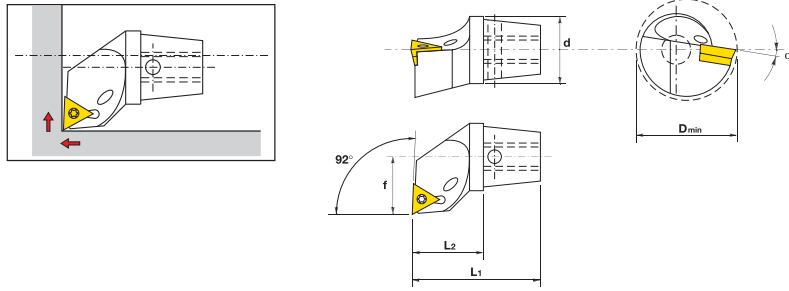

Referencia	Dimensiones (mm)						Piezas de repuesto				
	d	f	L ₁	L ₂	α	D _{min}					
T53S-32-TC16	32	27	58	33	8°	45	SZTP-322	SD 110	P-M4x10/15A	TORX-P-15	UNI 2415-3

T27M

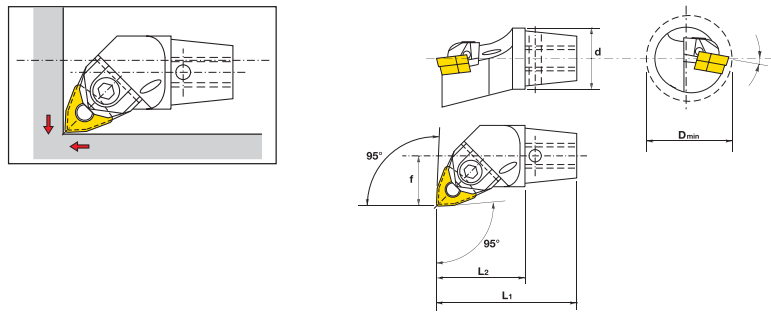

Referencia	Dimensiones (mm)						Piezas de repuesto				
	d	f	L ₁	L ₂	α	D _{min}					
T27M-32-WN 08	32	27	65	40	9°	45	28173	28260	E.28255	MW08-524-2,5-MM	UNI 2415-2,5
T27M-45-WN 08	45	35	70	40	9°	60	28173	28260	E.28255	MW08-524-2,5-MM	UNI 2415-2,5
T27M-55-WN 08	55	47.5	94	54	9°	78	28173	28260	E.28255	MW08-524-2,5-MM	UNI 2415-2,5

T64C

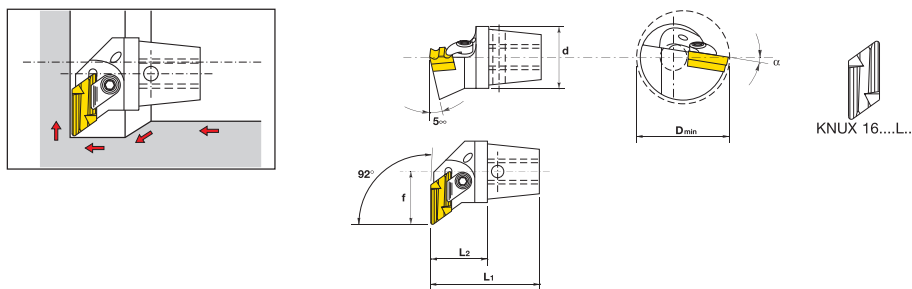

Referencia	Dimensiones (mm)						Piezas de repuesto				
	d	f	L ₁	L ₂	α	D _{min}					
T64C-32-KN16L	32	27	54	29	4°	45	KN-232 L	S2-10	M8x24 RL	MC 6 L	UNI 2415-4
T64C-45-KN16L	45	35.5	65	35	2°	60	KN-232 L	S2-10	M8x24 RL	MC 6 L	UNI 2415-4

Ejemplo de pedido: T53S-32-TC16

HERRAMIENTAS SOLDADAS Y SÓLIDAS

A3 A3T

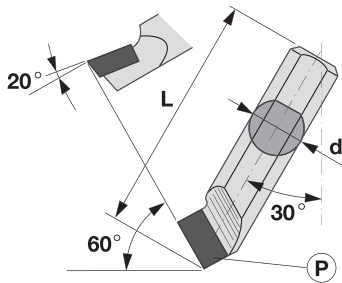

	Referencia	Sección	Dimensiones (mm)		Plaquita
			d	L	P
A3	A3-07		7	26	C7
	A3-08		8	30	C7
	A3-10		10	45	C8
	A3-12		12	55	C10
	A3-16		16	70	C12
A3T	A3T-04		4	18	-
	A3T-05		5	20	-

A4 A4T

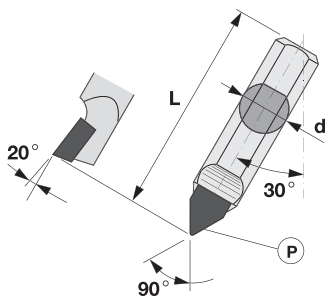

	Referencia	Sección	Dimensiones (mm)		Plaquita
			d	L	P
A4	A4-07		7	26	E8-IMP
	A4-08		8	30	E8-IMP
	A4-10		10	45	E10-IMP
	A4-12		12	55	E12-IMP
	A4T		A4T-04		4
A4T-05	5	20	-		

C1 C1T

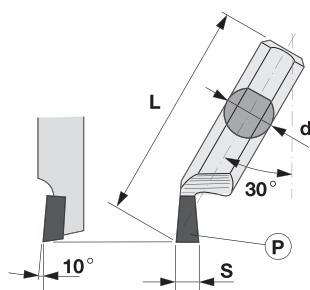

	Referencia	Sección	Dimensiones (mm)			Plaquita	S
			d	L	P		
C1	C1-07		7	26	GOR 3	3	
	C1-08		8	30	GOR 3	3	
	C1-10		10	45	GOR 4	4	
	C1-12		12	55	GOR 5	5	
	C1-16		16	70	GOR 6	6	
	C1-22		22	100	GOR 8	8	
	C1T		C1T-04		4	18	-
C1T-05		5	20		-	3.5	

Ejemplo de pedido: A3-07

HERRAMIENTAS SOLDADAS Y SÓLIDAS

TORNEADO

C2/60° C2/60°T

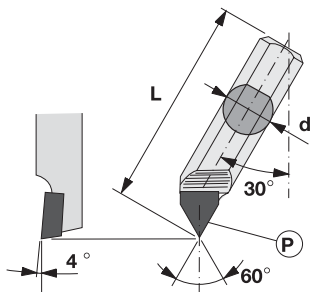

	Referencia	Sección	Dimensiones (mm)		Plaquita
			d	L	P
C2/60°	C2/60°-07		7	26	E8-IMP
	C2/60°-08		8	30	E8-IMP
	C2/60°-10		10	45	E10-IMP
	C2/60°-12		12	55	E12-IMP
	C2/60°-16		16	70	DA 12
	C2/60°-22		22	100	DA 16
C2/60°T	C2/60°T-04		4	18	-
	C2/60°T-05		5	20	-

C2/55° C2/55°T

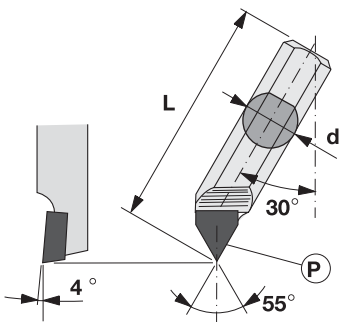

	Referencia	Sección	Dimensiones (mm)		Plaquita
			d	L	P
C2/55°	C2/55°-07		7	26	E8-IMP
	C2/55°-08		8	30	E8-IMP
	C2/55°-10		10	45	E10-IMP
	C2/55°-12		12	55	E12-IMP
C2/55°T	C2/55°T-04		4	18	-
	C2/55°T-05		5	20	-

C3 C3T

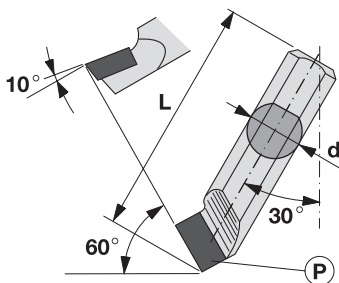

	Referencia	Sección	Dimensiones (mm)		Plaquita
			d	L	P
C3	C3-07		7	26	C7
	C3-08		8	30	C7
	C3-10		10	45	C8
	C3-12		12	55	C10
	C3-16		16	70	C12
	C3-22		22	100	C16
C3T	C3T-04		4	18	-
	C3T-05		5	20	-

Ejemplo de pedido: C2/60°-07

HERRAMIENTAS SOLDADAS Y SÓLIDAS

C4 C4T

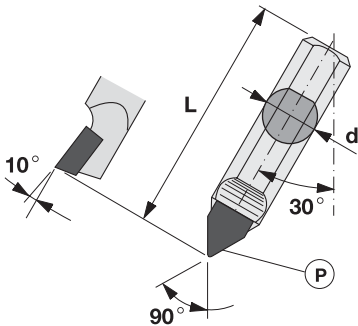

	Referencia	Sección	Dimensiones (mm)		Plaquita
			d	L	P
C4	C4-07		7	26	E8-IMP
	C4-08		8	30	E8-IMP
	C4-10		10	45	E10-IMP
	C4-12		12	55	E12-IMP
	C4-16		16	70	FB 14
	C4-22		22	100	FB 16
C4T	C4T-04		4	18	-
	C4T-05		5	20	-

C5 C5T

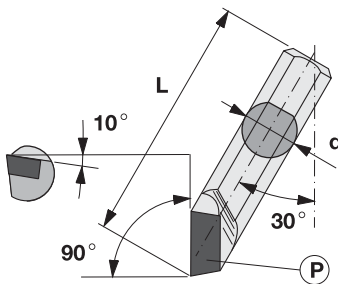

	Referencia	Sección	Dimensiones (mm)		Plaquita
			d	L	P
C5	C5-07		7	26	C7
	C5-08		8	30	C7
	C5-10		10	45	C8
	C5-12		12	55	ABC 10
	C5-16		16	70	ABC 12
	C5-22		22	100	ABC 16
C5T	C5T-04		4	18	-
	C5T-05		5	20	-

C6 C6T

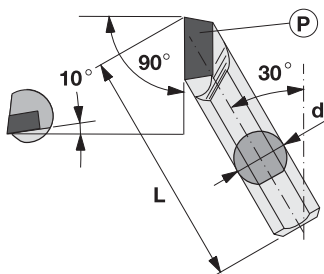

	Referencia	Sección	Dimensiones (mm)		Plaquita
			d	L	P
C6	C6-07		7	26	C7
	C6-08		8	30	C7
	C6-10		10	45	C8
	C6-12		12	55	ABC 10
	C6-16		16	70	ABC 12
	C6T		C6T-04		4
C6T-05	5	20	-		

Ejemplo de pedido: C4-07

HERRAMIENTAS SOLDADAS Y SÓLIDAS

D2/60° D2/60°T

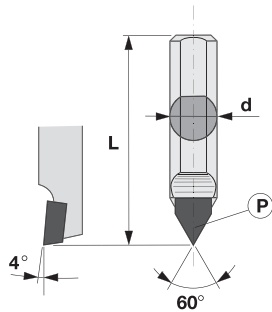

	Referencia	Sección	Dimensiones (mm)		Plaquita
			d	L	P
D2/60°	D2/60°-07		7	26	E8-IMP
	D2/60°-08		8	30	E8-IMP
	D2/60°-10		10	45	E10-IMP
	D2/60°-12		12	55	E12-IMP
	D2/60°-16		16	70	FB 14
D2/60°T	D2/60°T-04		4	18	-
	D2/60°T-05		5	20	-

D2/55°

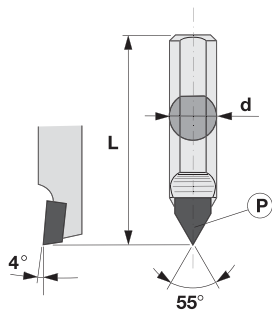

	Referencia	Sección	Dimensiones (mm)		Plaquita
			d	L	P
D2/55°	D2/55°-08		8	30	E8-IMP
	D2/55°-10		10	45	E10-IMP
	D2/55°-12		12	55	E12-IMP

D5 D5T

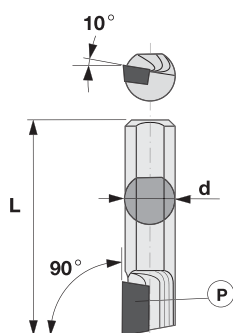

	Referencia	Sección	Dimensiones (mm)		Plaquita
			d	L	P
D5	D5-07		7	26	C7
	D5-08		8	30	C7
	D5-10		10	45	C8
	D5-12		12	55	ABC 10
	D5-16		16	70	ABC 12
D5T	D5T-04		4	18	-
	D5T-05		5	20	-

Ejemplo de pedido: D2/60°-07

HERRAMIENTAS SOLDADAS Y SÓLIDAS

D6 D6T

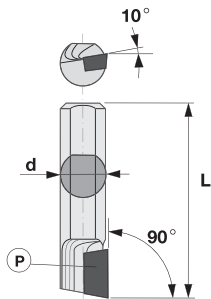

	Referencia	Sección	Dimensiones (mm)		Plaquita
			d	L	P
D6	D6-07		7	26	C7
	D6-08		8	30	C7
	D6-10		10	45	C8
	D6-12		12	55	ABC 10
	D6-16		16	70	ABC 12
D6T	D6T-05		05	20	-

Ejemplo de pedido: D6-07

HERRAMIENTAS CON PLAQUITAS INDEXABLES

M20C

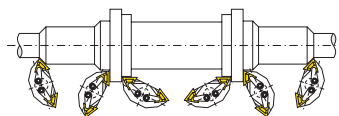
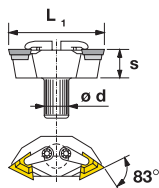
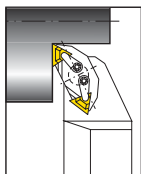

Referencia	Dimensiones (mm)			Piezas de repuesto							
	d	s	L ₁								
M20C-RL14-TP16	14	22	54	TP 212	S2-10	MC 2	M6x19 RL	UNI 2415-3	1.5-2.5	MT21-MT22	
M20C-RL16-TP16	16	22	57	TP 212	S2-10	MC 2	M6x19 RL	UNI 2415-3	1.5-2.5	MT21-MT22	

M26S

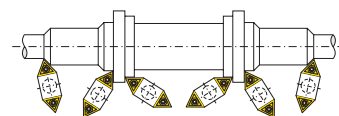
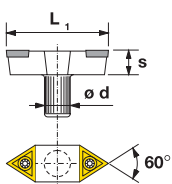
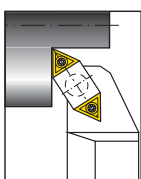

Referencia	Dimensiones (mm)			Piezas de repuesto						
	d	s	L ₁							
M26S-RL10-TC11	10	8.5	33	-	-	-	5513 020-03	TORX 7		
M26S-RL12-TC11	12	12	37.5	-	-	-	5513 020-03	TORX 7		
M26S-RL14-TC16	14	15	46	-	-	-	TORX-P-M4x10/15A	TMD 703		
M26S-RL16-TC16	16	17	54	SZTP 322	SD 110	UNI 2415-3	TORX-P-M4x10/15A	TMD 703		
M26S-RL18-TC16	18	21	64	SZTP 322	SD 110	UNI 2415-3	TORX-P-M4x10/15A	TMD 703		

M27M

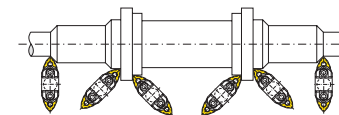
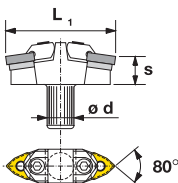
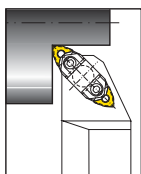

Referencia	Dimensiones (mm)			Piezas de repuesto				
	d	s	L ₁					
M27M-RL16-WN08	16	16	62	28173	28260	E.28255	MW08-524-2.5-MM	UNI 2415-2.5
M27M-RL18-WN08	18	19	66	28173	28260	E.28255	MW08-524-2.5-MM	UNI 2415-2.5

M24C

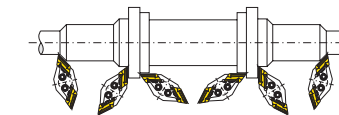
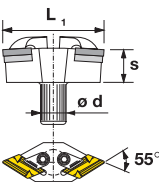
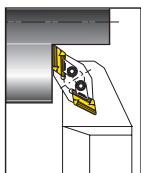

Referencia	Dimensiones (mm)			Piezas de repuesto						
	d	s	L ₁							
M24C-RL16-KN16	16	21	64	KN-232 R	KN-232 L	S2-10	MC 6 R	MC 6 L	M8x24 RL	UNI 2415-4

Ejemplo de pedido: M20C-RL14-TP16

HERRAMIENTAS SOLDADAS

FB

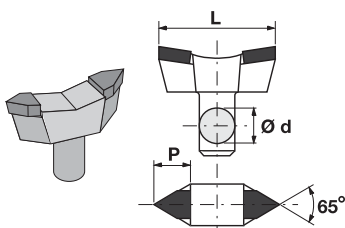

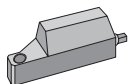
Referencia	Dimensiones (mm)		Plaquita	Utilizar con
	d	L	P	
FB-10	10	35	FB-10	 PTR
FB-12	12	44	FB-12	
FB-14	14	52	FB-14	
FB-16	16	58	FB-16	
FB-18	18	69	FB-18	
FB-22	22	87	FB-22	

FC

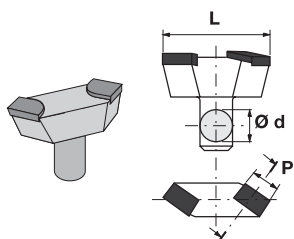

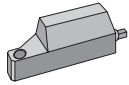
Referencia	Dimensiones (mm)		Plaquita	Utilizar con
	d	L	P	
FC-10	10	35	ABC 10	 PTR
FC-12	12	44	ABC 12	
FC-14	14	52	ABC 12	
FC-16	16	58	ABC 16	
FC-18	18	69	ABC 20	
FC-22	22	87	ABC 25	

FCS

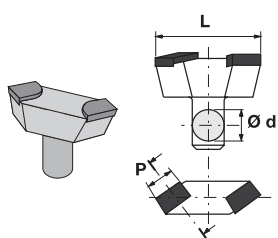

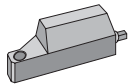
Referencia	Dimensiones (mm)		Plaquita	Utilizar con
	d	L	P	
FCS-14	14	44	ABC 12	 PTR
FCS-16	16	52	ABC 12	

DD

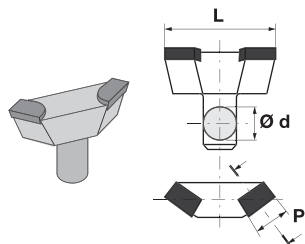

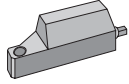
Referencia	Dimensiones (mm)		Plaquita	Utilizar con
	d	L	P	
DD-10	10	35	ABC 10	 PTR
DD-12	12	44	ABC 12	
DD-14	14	52	ABC 12	
DD-16	16	58	ABC 16	
DD-18	18	69	ABC 20	
DD-22	22	87	ABC 25	

ST

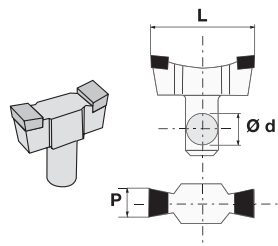

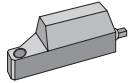
Referencia	Dimensiones (mm)		Plaquita	Utilizar con
	d	L	P	
ST-12	12	44	ABC 12	 PTR
ST-14	14	52	ABC 12	
ST-16	16	58	ABC 16	
ST-18	18	69	ABC 20	

Ejemplo de pedido: FB-10

HERRAMIENTAS SOLDADAS

F.60°

F.55°

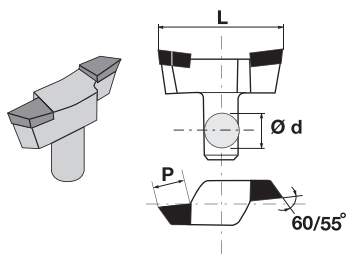

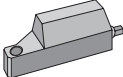
Referencia	Dimensiones (mm)		Plaquita	Utilizar con
	d	L	P	
F.60°-12	12	44	ABC 12	 PTR
F.60°-14	14	52	ABC 12	
F.60°-16	16	58	ABC 16	
F.55°-16	16	58	ABC 16	

CP

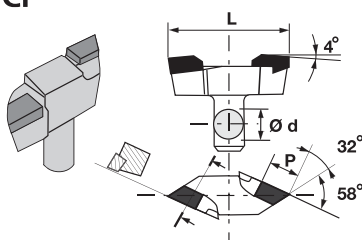

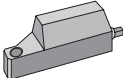
Referencia	Dimensiones (mm)		Plaquita	Utilizar con
	d	L	P	
CP-12	12	44	CP-12	 PTR
CP-14	14	52	CP-14	
CP-16	16	60	CP-16	

CPS

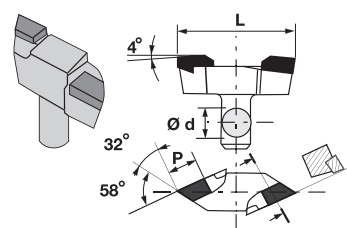

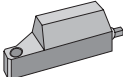
Referencia	Dimensiones (mm)		Plaquita	Utilizar con
	d	L	P	
CPS-14	14	52	CPS-14	 PTR
CPS-16	16	60	CPS-16	

DA

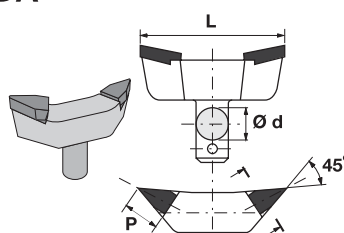

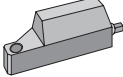
Referencia	Dimensiones (mm)		Plaquita	Utilizar con
	d	L	P	
DA-12	12	60	DA-12	 PTR
DA-14	14	70	DA-14	
DA-16	16	80	DA-16	
DA-18	18	90	DA-18	

DAI

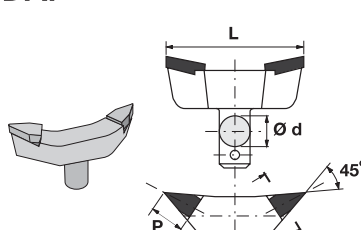

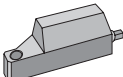

Referencia	Dimensiones (mm)		Plaquita	Utilizar con
	d	L	P	
DAI-14	12	60	E12-IMP	 PTR
DAI-16	14	70	DA-12	
DAI-18	16	80	DA-16	

Ejemplo de pedido: F.60°-12

SOPORTE PARA HERRAMIENTAS ROTATORIAS & CASQUILLOS PARA BARRAS DE MANDRINAR

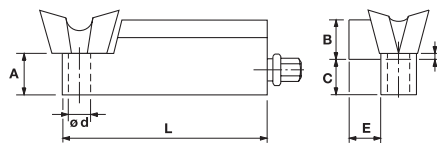
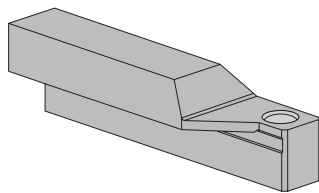
PTR



Referencia	Torreta	Dimensiones (mm)							Piezas de repuesto	
		d	A	B	C	E	L	I		
PTR-1313-10	O	10	19.5	13	16.5	13	125	3	1121	1504
PTR-1815-12	A	12	24	18	20	15	140	4	1121	1504
PTR-2118-14	B	14	30	21	26	18	135	4	1121	1504
PTR-2424-16	C	16	31	24	25	24	150	6	1161	1506
PTR-3030-18	D	18	40	30	33	30	240	7	1161	1506

Herramientas rotatorias para soportes PTR: ...

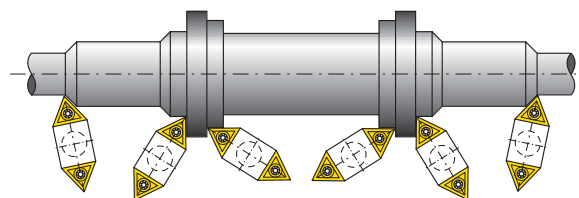
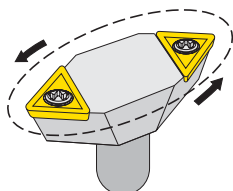
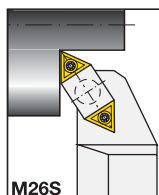

Esta herramienta puede, mediante la rotación de 360° sobre su propio eje, asumir numerosas posiciones de operación y en de este modo sustituir a varias herramientas convencionales.

P90

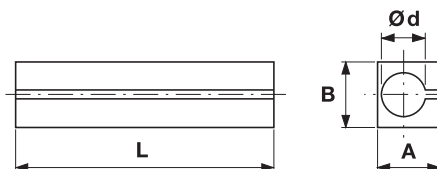
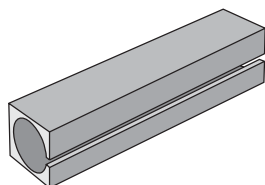



Referencia	Dimensiones (mm)			
	B	A	L	d
P90-1616-10	16	16	75	10
P90-1616-12	16	16	75	12
P90-2020-10	20	20	100	10
P90-2020-12	20	20	100	12
P90-2020-16	20	20	100	16
P90-2525-20	25	25	100	20
P90-3025-10	30	25	100	10
P90-3025-12	30	25	110	12
P90-3025-16	30	25	110	16
P90-3030-20	30	30	130	20
P90-3030-25	30	30	130	25
P90-3937-32	39	37	140	32

Ejemplo de pedido: PTR-1313-10

SOPORTE DINAMOMÉTRICO PARA CORTE

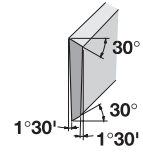
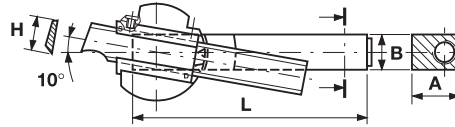
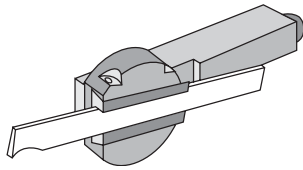
PDT



Referencia	Dimensiones (mm)				Piezas de repuesto	
	B	A	L	H		
PDT-2434-LU 20	24	34.5	170	20	UNI 5923 M6 x 10	UNI 2415 - 3

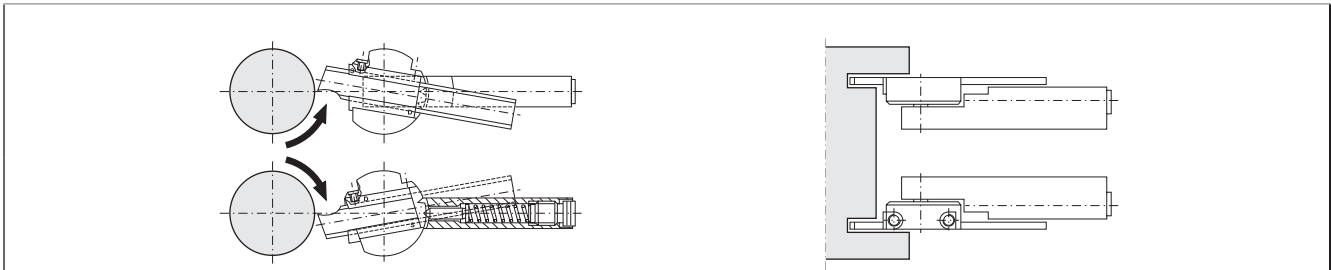

El portaherramientas PDT previene la rotura de las cuchillas gracias a la inclinación particular de la cuchilla y a un dispositivo dinamométrico ajustable que libera la cuchilla de la pieza que se va a mecanizar cuando la fuerza de corte sobrepasa el límite establecido.

Ejemplo de pedido: PDT-2434-LU 20

SOPORTE PARA CUCHILLAS DE TRONZADO TRAPEZOIDALES Y ROMBOIDES

MLT

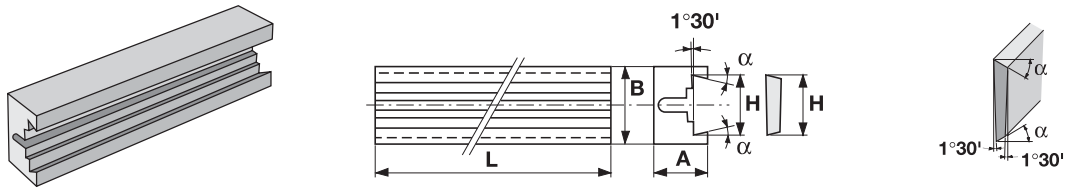

Referencia	Dimensiones (mm)				
	B	A	L	H	α
MLT-1612-LM 10	16	12	100	10	13°
MLT-2014-LM 13	20	14	110	13	13°
MLT-2518-LM 17	25	18	120	17	13°
MLT-3020-LM 20	30	20	125	20	13°
MLT-3422-LU 23	34	22	130	23.5	30°

P05

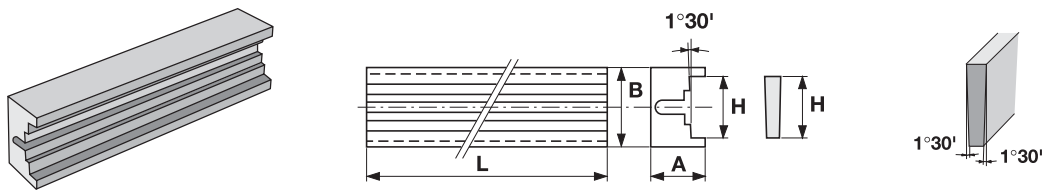

Referencia	Dimensiones (mm)			
	B	A	L	H
P05-2518-15	25	18	120	15
P05-3020-20	30	20	125	20

P04

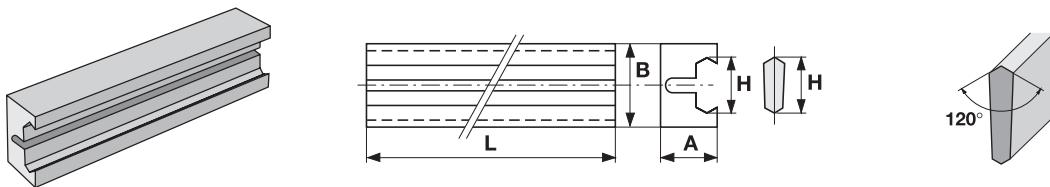

Referencia	Dimensiones (mm)			
	B	A	L	H
P04-3020-LC 20	30	20	125	20

Ejemplo de pedido: MLT-1612-LM 10

HERRAMIENTAS DE MOLDEADO HSS

Cuadrada

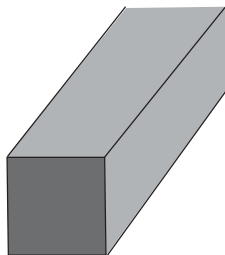

Referencia	
4 x 4 x 200	15 x 15 x 200
5 x 5 x 200	16 x 16 x 200
6 x 6 x 200	18 x 18 x 200
7 x 7 x 200	20 x 20 x 200
8 x 8 x 200	25 x 25 x 200
12 x 12 x 200	30 x 30 x 200
14 x 14 x 200	

Redonda

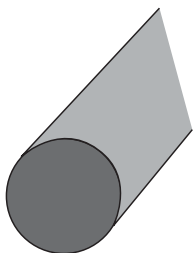

Referencia	
3 x 200 T	12 x 200 T
4 x 200 T	14 x 200 T
5 x 200 T	15 x 200 T
6 x 200 T	16 x 200 T
7 x 200 T	18 x 200 T
8 x 200 T	20 x 200 T
10 x 200 T	

Trapezoidal

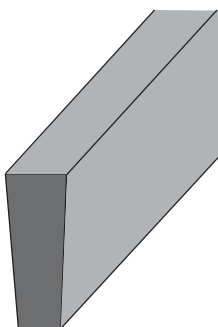

Referencia	
10 x 3 x 2 x 200	18 x 4 x 3 x 200
12 x 3 x 2 x 200	18 x 5 x 4 x 200
12 x 4 x 3 x 200	20 x 3 x 2 x 200
12 x 5 x 4 x 200	20 x 4 x 3 x 200
15 x 3 x 2 x 200	20 x 5 x 4 x 200
15 x 4 x 3 x 200	20 x 6 x 5 x 200
15 x 5 x 4 x 200	25 x 5 x 4 x 200
15 x 6 x 5 x 200	30 x 6 x 5 x 200
18 x 3 x 2 x 200	

HERRAMIENTAS DE MOLDEADO HSS

Rectangular

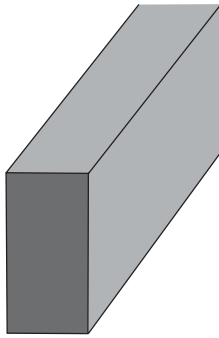

Referencia	
8 x 6 x 200	20 x 3 x 200
10 x 2 x 200	20 x 4 x 200
10 x 3 x 200	20 x 5 x 200
10 x 4 x 200	20 x 6 x 200
10 x 5 x 200	20 x 8 x 200
10 x 6 x 200	20 x 10 x 200
10 x 8 x 200	20 x 12 x 200
12 x 3 x 200	20 x 15 x 200
12 x 4 x 200	25 x 5 x 200
12 x 5 x 200	25 x 6 x 200
12 x 6 x 200	25 x 8 x 200
12 x 8 x 200	25 x 10 x 200
12 x 10 x 200	25 x 12 x 200
15 x 3 x 200	25 x 15 x 200
15 x 4 x 200	30 x 4 x 200
15 x 5 x 200	30 x 5 x 200
15 x 6 x 200	30 x 6 x 200
15 x 8 x 200	30 x 8 x 200
15 x 10 x 200	30 x 10 x 200
16 x 6 x 200	30 x 12 x 200
16 x 8 x 200	30 x 15 x 200
16 x 10 x 200	30 x 20 x 200
16 x 12 x 200	

SOPORTES DE HERRAMIENTAS GIRATORIOS

PIGRECA R

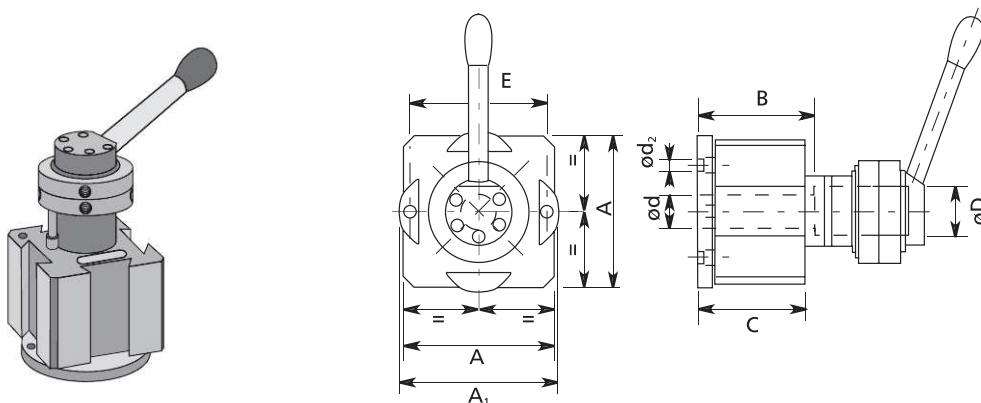

Referencia	Dimensiones (mm)								∠	Xm		H P
	A	A ₁	B	C	D ₁	E	d	d ₂		min.	max.	
PIGRECA R-B-4/125	125	133	132	105	42	116	20.5	8.5	20 25	36 41	50 55	3 ÷ 10
PIGRECA R-B-4/125 + DR	125	133	132	105	42	116	20.5	8.5	20 25	36 41	50 55	3 ÷ 10
PIGRECA R-C-4/140	140	146	132	105	42	127	20.5	8.5	20 25 32	38 43 50	50 55 62	6 ÷ 15
PIGRECA R-C-4/140 + DR	140	146	132	105	42	127	20.5	8.5	20 25 32	38 43 50	50 55 62	6 ÷ 15

P3/70

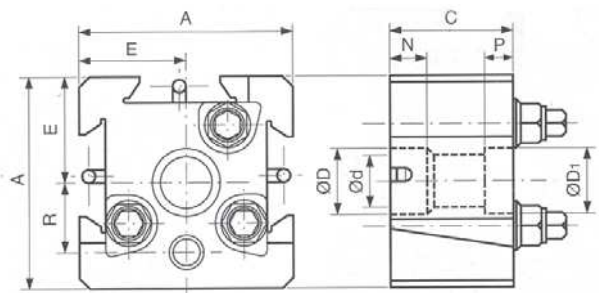
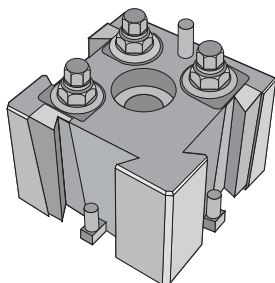

Referencia	Dimensiones (mm)									Xm		
	A	C	D	D ₁	d	E	N	P	R	min.	max.	
P3/70-96-3-A	96	65	-	32	23	48	-	10	34.5	20	30	1517
P3/70-115-3-B	115	80	50	38	28	57.5	30	15	45	25	45	1518
P3/70-143-3-C	143	95	50	48	36	71.5	35	23	55	35	55	1519
P3/70-174-3-D	174	110	60.5	60	40	87	40	20	65	45	65	1521
P3/70-214-3-D	214	140	70	70	50	107	50	30	85	55	75	1526

Ejemplo de pedido: PIGRECA R-B-4/125

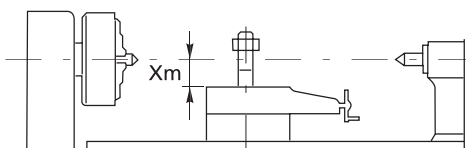

SOPORTE UNIVERSAL

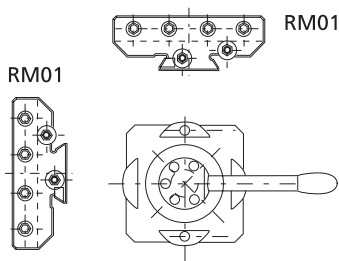
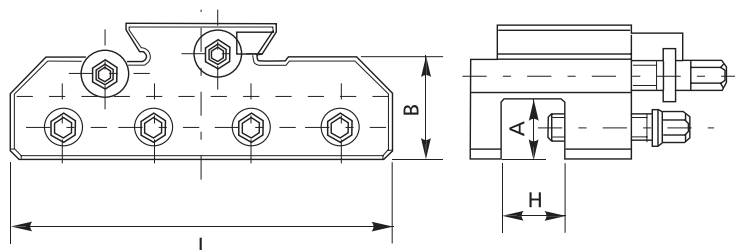
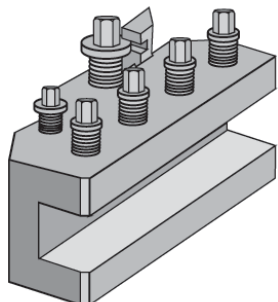

RM01

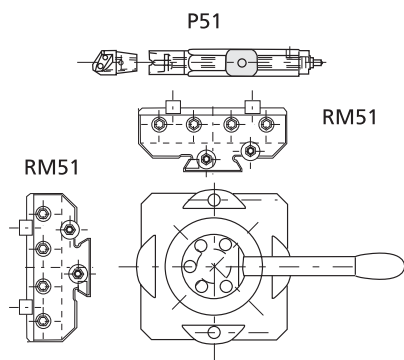
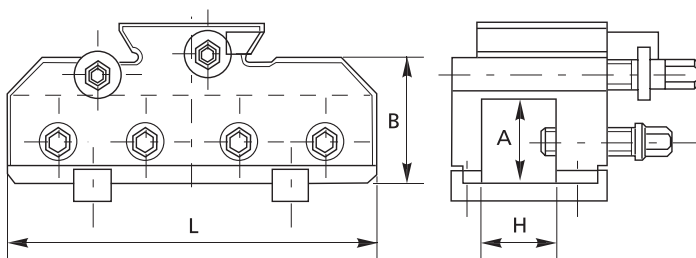
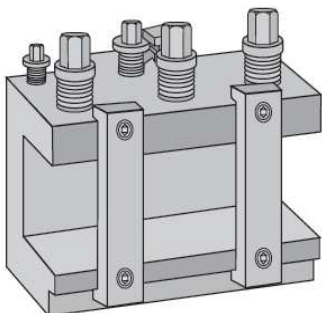

Referencia	Dimensiones (mm)				Piezas de repuesto
	H	A	B	L	
RM01-B-30	30	22	38	140	1534
RM01-C-32	34	25	40	160	1536

RM51





Referencia	Dimensiones (mm)				Piezas de repuesto	
	H	A	B	L		
RM51-B-40	40.5	37	51.5	118	1518	1534
RM51-C-40	40.5	37	52	140	1518	1536

Ejemplo de pedido: RM01-B-30

PORTAHERRAMIENTAS DE CONO MORSE & PORTAHERRAMIENTAS MÚLTIPLE

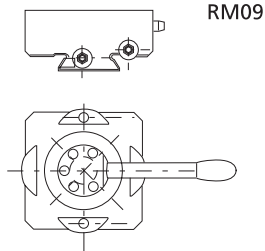
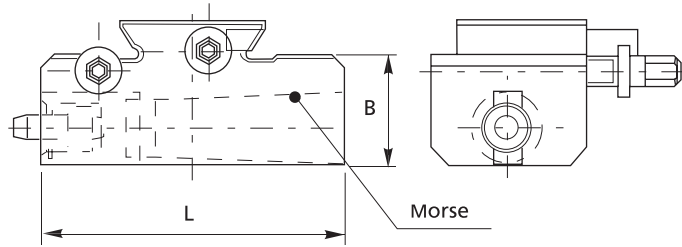
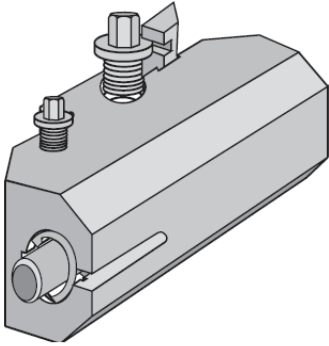
RM09



Referencia	Morse	Dimensiones (mm)		Piezas de repuesto
		B	L	
RM09-A/B-3	N. 3	44.5	115	1534
RM09-C-4	N. 4	52	146	1536

RM71

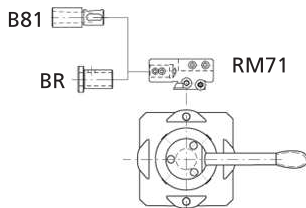
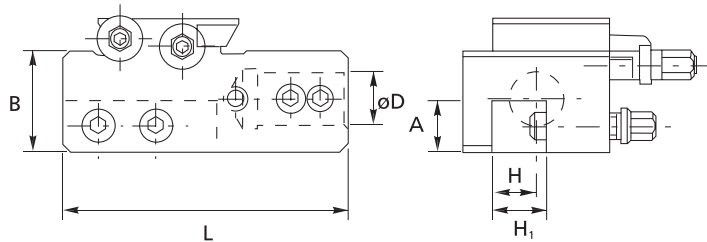
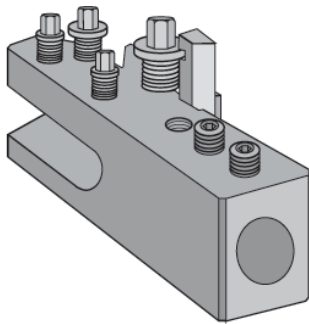





Referencia	Dimensiones (mm)					Piezas de repuesto
	D _{H8}	H	A	B	L	
RM71-B-032-2525	32	25	25	45	155	1534
RM71-C-032-2525	32	25	25	45	165	1536

Ejemplo de pedido: RM09-A/B-3

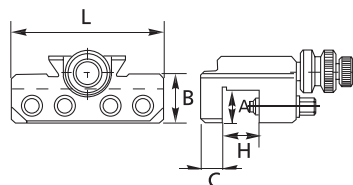
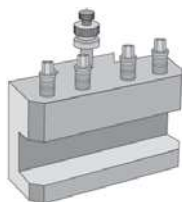
SOPORTES PARA SOPORTES DE HERRAMIENTAS P3/70



S01

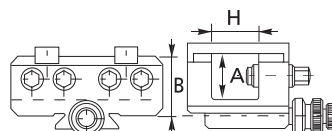
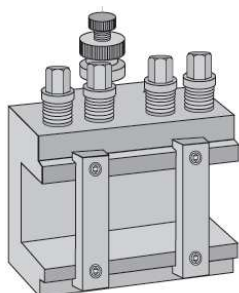

Referencia	Dimensiones (mm)					Piezas de repuesto		
	H	L	A	B	C			
S01-A-25	26	94	17	31	13	1101	1531	A
S01-B-30	30	108	22	33.5	15	1109	1531	B
S01-C-32	34	136	26	43	17	1121	1531	C
S01-D-32	34	162	26	44	18	1121	1531	D

S51

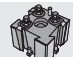

Referencia	Dimensiones (mm)			Piezas de repuesto		
	H	A	B			
S51R-B-40	42	41	55	1182	1519	B
S51-C-40	42	41	55	1182	1519	C
S51-C-56	58	47	73	1182	1519	C
S51-D-40	42	41	63	1182	1519	D
S51-D-56	58	47	71	1182	1519	D
S51-D-76	80	62	93	1182	1519	D

Ejemplo de pedido: S51R-B-40

SOPORTES DE CONO MORSE PARA SOPORTES P3/70

S09

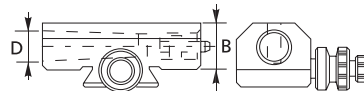
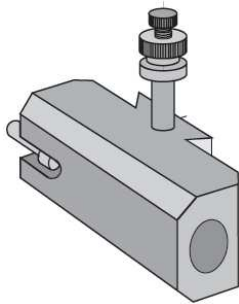

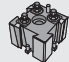
Referencia	Soporte cono morse para torreta	Dimensiones (mm)		Piezas de repuesto
		D	B	
S09-A-2	Nº 2	17.720	31	A
S09-B-3	Nº 3	23.825	35.5	B
S09-C-4	Nº 4	31.267	42	C
S09-D-5	Nº 5	44.399	57	D

Ejemplo de pedido: S09-A-2

DISTRIBUIDOR DE REFRIGERANTE Y ACCESORIOS

DR

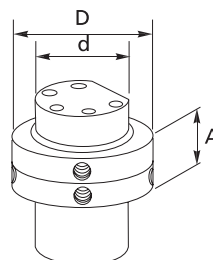
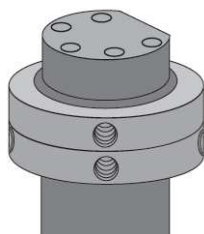

Referencia	Dimensiones (mm)		
	A	d	D
DR-B/C	33	65	100

Ejemplo de pedido: DR-B/C

SET-ALR

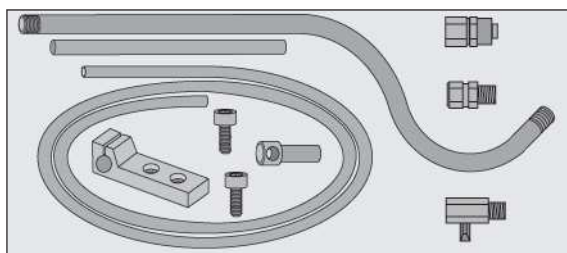

SET-ALR-B/C	
1	VITE T.C.E.I. M6x14
1	VITE T.C.E.I. M8x16
1	ARRESTO ASTA PER SET ALR
1	TERMIN. PER ASTA SET ALR
1	TUBO DIS. 14455/1 POS. 3
1.5000	TUBO RILSAN NEUT. D.E.10x8
1	ASTA PER SET ALR-A-B/C
1	RACC. GIR. 1/4 GAS M2541 CL
1	RAC.R.8/10-1/4GAS M1463CL
1	GUARN.NAY.1/4GAS A.2661CL
1	RUB. RB 3831 1/4

FÓRMULAS DE TORNEADO

Parámetros a determinar		Parámetros conocidos		Fórmula
Velocidad de corte (m/min)	v_c	Diámetro mecanizado (mm)	D_m	$v_c = \frac{\pi \times D_m \times n}{1000}$
		Revoluciones del husillo (r/min)	n	
Revoluciones del husillo (r/min)	n	Velocidad de corte (m/min)	v_c	$n = \frac{1000 \times v_c}{\pi \times D_m}$
		Diámetro mecanizado (mm)	D_m	
Tiempo de corte (min)	T	Longitud mecanizada (mm)	l_m	$T = \frac{l_m}{f_n \times n}$
		Avance por revolución (mm/r)	f_n	
		Revoluciones del husillo (r/min)	n	
Rugosidad (μm)	R_t	Avance por revolución (mm/r)	f_n	$R_t = \frac{f_n^2}{r_\epsilon} \times 125$
		Radio de la punta de la plaquita (mm)	r_ϵ	
Caudal de viruta (cm^3/min)	Q	Velocidad de corte (m/min)	v_c	$Q = v_c \times a_p \times f_n$
		Profundidad de corte (mm)	a_p	
		Avance por revolución (mm/r)	f_n	
Potencia necesaria (kW)	P_c	Caudal de viruta (cm^3/min)	Q	$P_c = \frac{Q \times K_{c0.4}}{60000} \times \left(\frac{0.4}{f_n \times \sin \kappa_r} \right)^{0.22}$
		Fuerza de corte específica para espesor de virutas = 0,4 mm (N/mm^2)	$K_{c0.4}$	
		Avance por revolución (mm/r)	f_n	
		Ángulo de ataque (grados)	κ_r	
Par (Nm)	c	Potencia necesaria (kW)	P_c	$c = \frac{30000 \times P_c}{\pi \times n}$
		Revoluciones del husillo (r/min)	n	